

# 4327 SPRING FOREST LANE

WESTLAKE VILLAGE, CA 91362

## Estimated Total Finished Square Footage: 7,185 SQ FT

Above-Grade: 6,900 SQ FT Below-Grade: 285 SQ FT

- **Main Residence: 6,785 SQ FT**

Main Level: 6,500 SQ FT

Lower Level: 285 SQ FT

- **Pool House: 400 SQ FT**

Plus 715 SQ FT 3-Car Garage on Lower Level  
*Calculated per ANSI Standard Z765-2003*

\* Estimated Total Finished & Unfinished  
Square Footage: 7,900 SQ FT

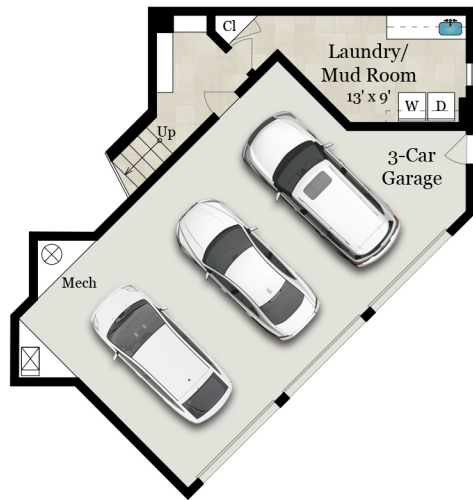

MAIN RESIDENCE  
LOWER LEVEL

285 SQ FT

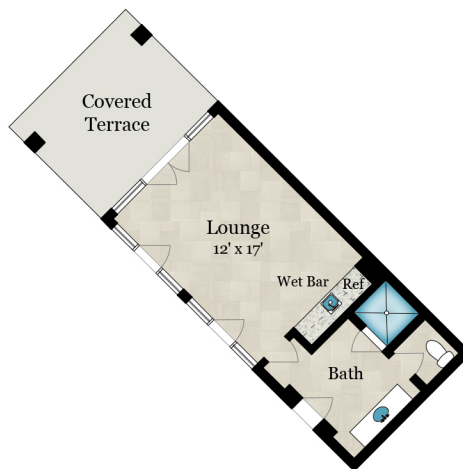

POOL HOUSE

400 SQ FT

