

Partial Lot Shown

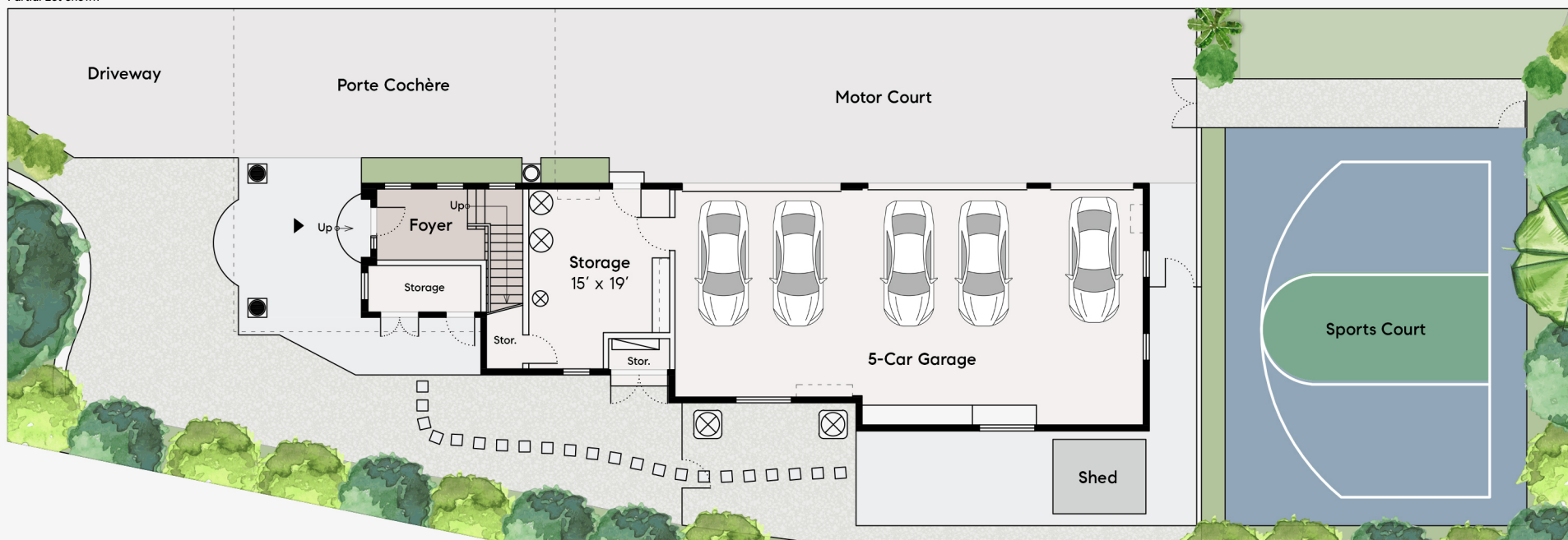

**DETACHED GARAGE / GUEST HOUSE ENTRANCE**

1,635 SQ FT - Detached Garage  
200 SQ FT - Guest House

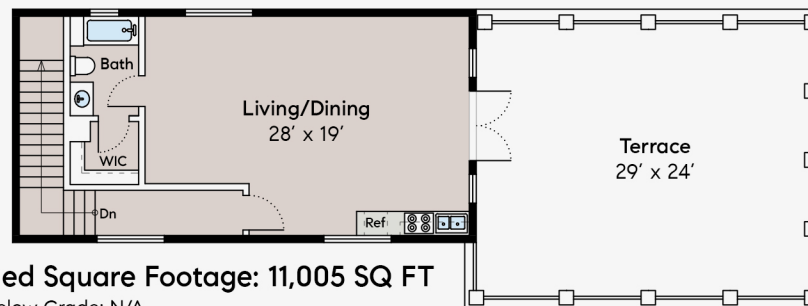

**GUEST HOUSE SECOND FLOOR**  
815 SQ FT

**Estimated Total Finished Square Footage: 11,005 SQ FT**

Above-Grade: 11,005 SQ FT Below Grade: N/A

- Main Residence: 9,990 SQ FT
- Guest House: 1,015 SQ FT
- Main Level: 5,385 SQ FT
- Entrance: 200 SQ FT
- Upper Level: 4,605 SQ FT
- Second Floor: 815 SQ FT

Plus 1,255 SQ FT Detached 5-Car Garage  
Plus 380 SQ FT Storage (Detached Garage)  
*Calculated per ANSI Standard Z765-2003.*

\* Estimated Total Finished & Unfinished Square Footage: 12,640 SQ FT

- Window
- Door
- Interior Wall
- Exterior Wall

**224 W Stafford Road**  
**Thousand Oaks**

5 Bed | 5.5 Bath

